

# OUTPOST

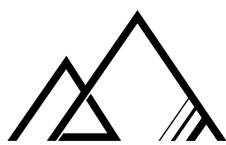

## TURTLE SERIES

The Turtle Series provides you with the high end Outpost shell so you can finish it out how you wish.

Meant for the do it yourselfers, who want their specific twist on how the interior is finished out. This model opens up to those who may not want a half bath in the space for a larger man cave, she shed, art studio, etc.

The Turtle Shell comes with the completed exterior including glass, metal panels, exterior door and subfloor. The ac, heat, power, plumbing, lighting, and interior fit is not included. Leaving these elements to whatever you may want to create for your unique adventure.





Turtle Shell Layout

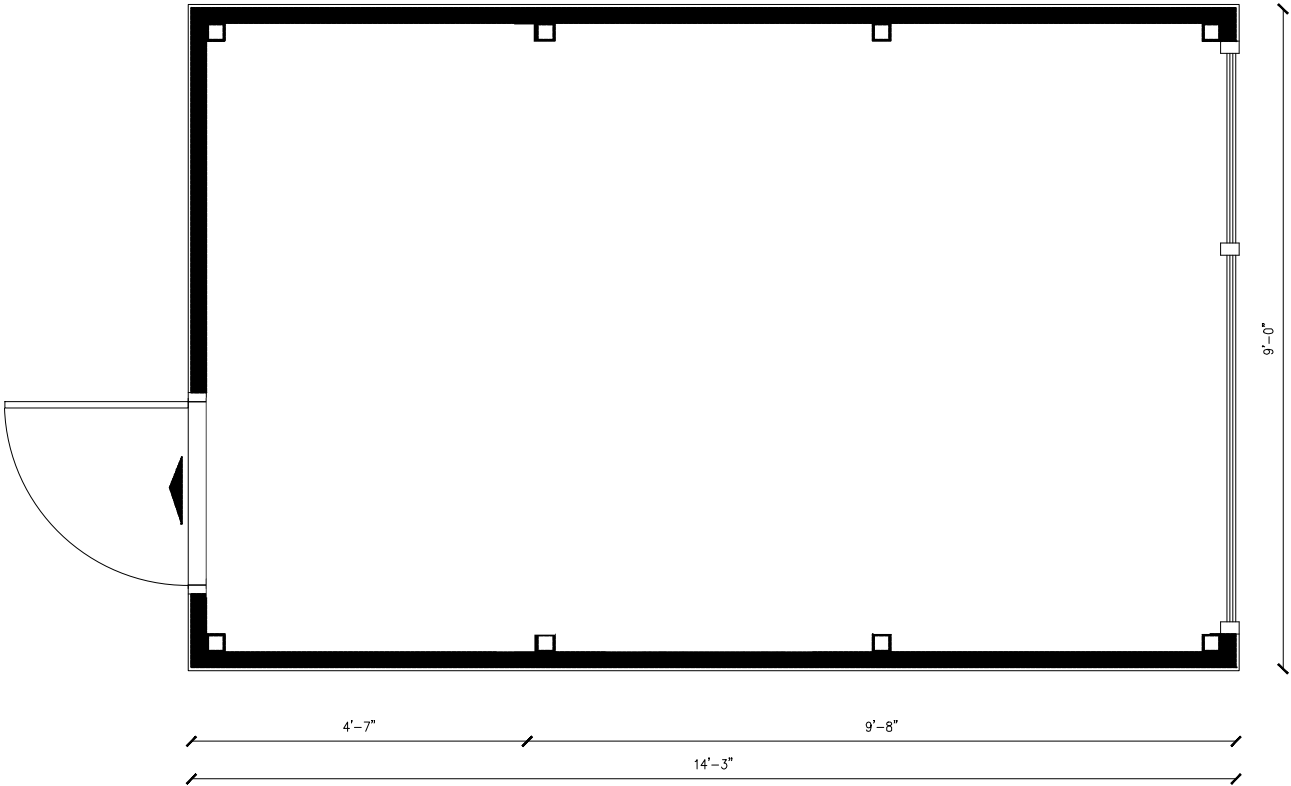



## Placement

Weighing only 4,600 lbs unfurnished, Outposts are made to be as adventurous as you like. We recommend you prepare your site based on local jurisdictional requirements along with what amenities you have chosen. We recommend anchoring your Outpost to either concrete foundations, thickened slab, or concrete sonotubes if you wish to keep a minimal footprint on your amazing site. Anchor plates are welded at the base of each corner. Lifting anchors are on the roof of each Outpost to allow easy lifting from trailer to site via telehandler, mini crane, even helicopter if you are getting extremely remote.



Visualization Section  
Displays looking through an exterior wall of an Outpost.  
Provided by Annex Designs